

Creating a group

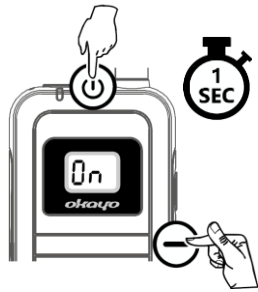

Press and hold the buttons \downarrow and $-$ on the Okayo EarME FIT transmitter to start grouping.

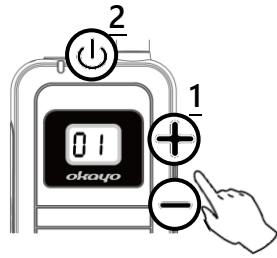

Select the channel using the buttons $+$ and $-$ (1). Confirm by pressing (2).

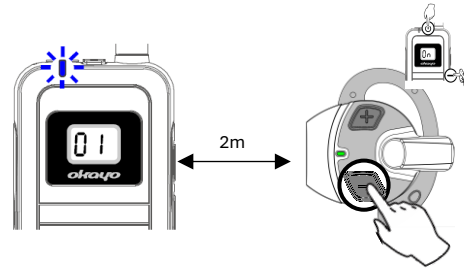

When the pairing indicator is blinking on the transmitter, press \downarrow (-) on the Okayo EarME FIT receiver to turn it on. The receiver is paired when the LED on the receiver shines steadily.



Press the button \downarrow to finish pairing and start the tour.

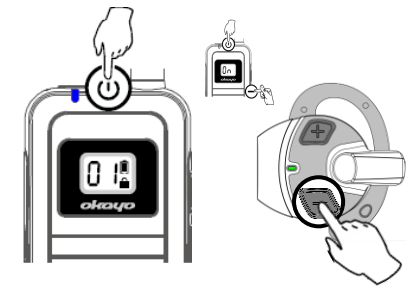

If there are no changes to the group, press \downarrow on the transmitter to turn the unit on.

General settings

Muting the microphone



Short-press the button \downarrow on the transmitter to turn the microphone on/off.

Amplifying the microphone



Press and hold the button $+$ on the transmitter until 'U2' shows up on the display (AUR1 and U1-U2, default setting is U2)

Adjusting the volume

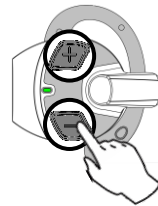

Press $+$ or $-$ on the receiver to select the volume.

Checking the battery level when the Okayo EarME FIT is off



Press both $+$ and $-$ simultaneously to check the battery level if the receiver is off.

75%↑	Steady green
50~75%	Blinking green
25~50%	Blinking green and red
25%↓	Steady red *ca. 30 min. left

Energy saving

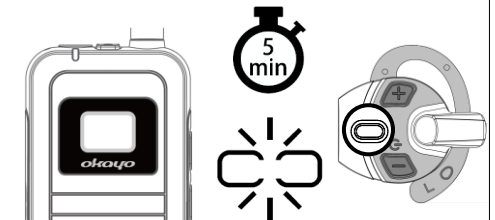

After five minutes without receiving a signal, the receiver will shut off automatically.

^{R1} This setting is recommended when connecting the transmitter to an external sound source using the 3.5 mm jack. The microphone remains muted.

Joining the group during the tour

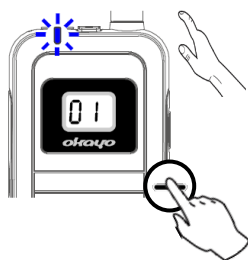

Press the button **-** on the transmitter to start pairing during a tour.

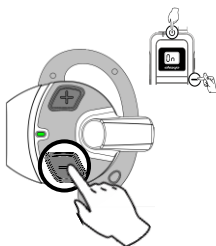

Press the button **⏻** on a new receiver to turn it on. The new receiver is paired if the diode light is constant.



Short-press the button **⏻** on the transmitter to complete pairing and restart the tour.

Remote channel change

Should it become necessary to change the group channel, it can be done at any time.



Press and hold both **+** and **-** buttons on the receiver to unlock the channel change function. Select the channel using **+** or **-**. After one second the channel will automatically be confirmed.

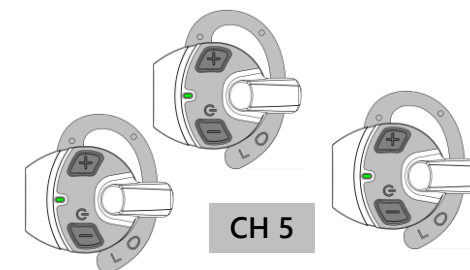

All receivers will be automatically moved to the new channel.

Remotely ending a tour

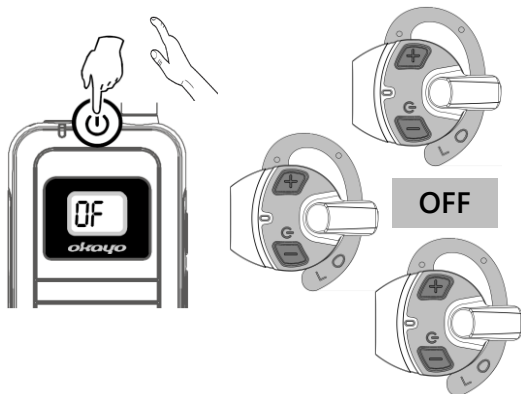

If the transmitter is off, all receivers will shut down automatically.

LED indicators

Model	Okayo EarME FIT T (transmitter)	Okayo EarME FIT R (receiver)
Status		
High power	Blue	Green
Low power	Red	
Pairing under way	Quick blinking	
Devices paired	Steady light	
Mute	Slow blinking	-

Battery level (transmitter)

50%↑	
5~50%	
5%↓	
	*30 minutes remaining

⚠ BATTERY WARNING ⚠

- Charge the unit regularly if the battery level drops below 50%.
- Make sure the units are fully charged before long-term storage.
- Should the unit overheat or the battery experience problems with durability or behave in an extraordinary manner, contact the service team.